

The Ritz-Carlton Hotel and Condominium

Case Study



Project Overview

Located in the heart of the City of Toronto, The Ritz-Carlton Hotel and Condominium is an upscale establishment that lives up to its name. Completed in February 2011, this 53 floor postmodern building epitomizes quality both inside the walls and out.

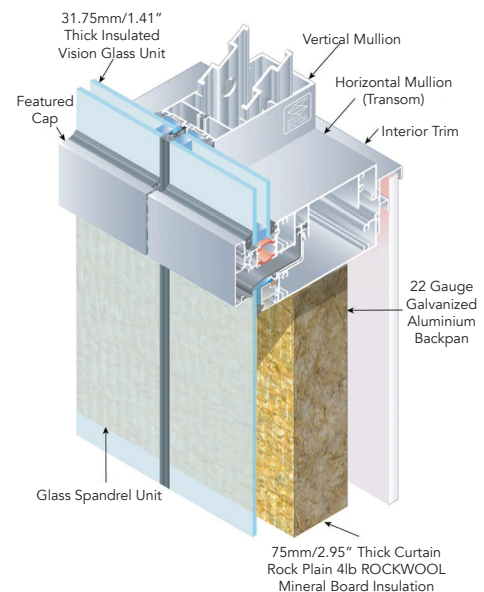



ROCKWOOL Products Used

CURTAINROCK® is a lightweight, semi-rigid stone wool insulation board designed for curtain wall systems.

ROXUL SAFE™ is a lightweight, semi-rigid stone wool insulation and is UL and Intertek approved as a forming material for numerous fire stop systems. It is designed to fill perimeter gaps between concrete floor slabs and exterior wall systems, between fire walls and ceiling slabs and around conduit pipes and duct openings through walls and floor slabs. SAFE™ is always used in conjunction with a fire sealant to prevent passage of fire and smoke from one floor to the next.

AFB® is a light weight, semi rigid batt insulation specifically designed for steel stud interior wall and floor applications due to its superior sound absorbency and fire protection.

FABROCK™ LT is designed to insulate surfaces that require lasting thermal performance in moisture intense environments. In this application it was used to insulate the columns and beams.

ROCKBOARD® PG insulation is designed specifically for parking garage applications. ROCKBOARD® PG improves energy efficiency by insulating this part of the building envelope and features a reflective white polypropylene facing which brightens the space helping to reduce lighting investment costs by decreasing the amount of lights needed in this part of the building.

Benefits of ROCKWOOL Insulation

ROCKWOOL stone wool insulation has a long term stable R-value, is dimensionally stable, non-combustible, water repellent, non-corrosive, sound absorbent, will not promote fungi growth and is environmentally sustainable. ROCKWOOL is pleased to have third-party certification of our products' recycled content for our Milton facility completed by ICC -ES SAVE™. All ROCKWOOL products produced in the Milton facility contain a minimum of 40% recycled content. ROCKWOOL products produced in our Grand Forks facility are currently awaiting ICC -ES SAVE™ certification.



“We rely on ROCKWOOL not only for their consistent product quality, ready delivery and competitive pricing, but also for their superior technical expertise”

SOTA GLAZING INC.

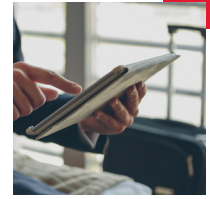

Architects

Page + Steele Architects (Toronto)
95 St. Clair Ave. W. Suite 200
Toronto ON, M4V 1N6
416.924.9966

Design Architect: Kohn Pedersen Fox-NY
11 West 42nd Street
New York, NY 10036
212.977.6500

Contractor

EllisDon Corporation
89 Queensway Ave W, Suite 800
Mississauga, ON L5B 2V2
905.896.8900

Sub Contractors

Sota Glazing Inc. (Curtain Wall)
Marel Contractors (Drywall)
Blandford Construction (Parking Garage)

Location:

Toronto, ON

Project Timeline:

2010-2011

Curtain Wall:

9,290 m² of 4" CURTAINROCK®

Columns & Beams:

1,858 m² of FABROCK™ LT

Firestops:

2,322 m² of ROXUL SAFE™

Parking Garage:

1,858 m² of ROCKBOARD® PG

Interior Partitions:

23,226 m² of AFB®

ROCKWOOL

8024 Esquesing Line
Milton, ON L9T 6W3
Tel: 1 800 265 6878
rockwool.com